

ARMORLITE TECHNOLOGIES INC

RT 3.0 OPERATORS MANUAL

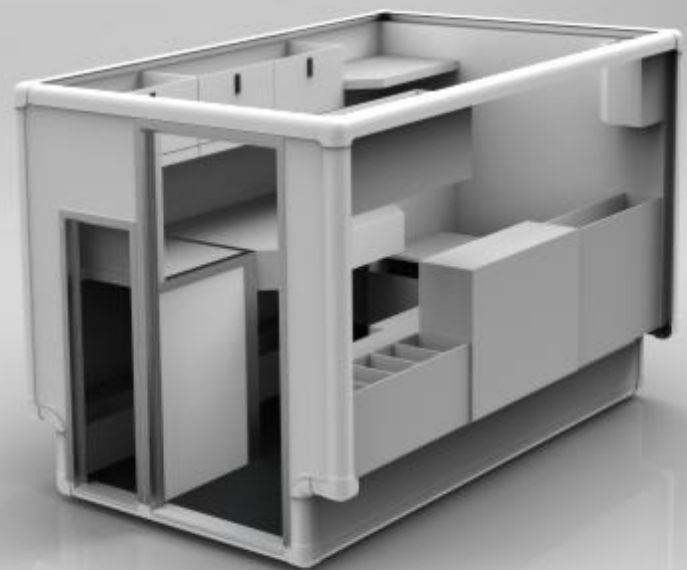

Table of Contents

PREFACE	2
PRODUCT INFORMATION	3
PRODUCT WARRANTY	4
IMPORTANT INFORMATION	5
BOLT DOWN INFORMATION	6
CO MONITOR / 120VAC BREAKER	8
ELECTRICAL	9
PLUMBING AND HEATING	12
DRYER OPERATION	13
CARE AND MAINTENANCE	14
SPECIFICATIONS	15
REPLACEMENT PARTS	16

NDT Supply.com, Inc.

7952 Nieman Road
Lenexa, KS 66214-1560 USA

Phone: 913-685-0675, Fax: 913-685-1125
e-mail: sales@ndtsupply.com, www.ndtsupply.com



Preface

Thank you for choosing Armorlite Tech Inc. Please read the following general information prior to usage.

1. This guide will provide you with information and specific instructions for the basic care of your unit(s).
2. Please note **WHEN ORDERING PARTS**, you should check the most up-to-date information as parts / part numbers may be subject to change.
3. Specifications are subject to change and no guarantee/ warranty implied to its accuracy because materials and parts are updated as required.

NDT Supply.com, Inc.

7952 Nieman Road
Lenexa, KS 66214-1560 USA

Phone: 913-685-0675, Fax: 913-685-1125
e-mail: sales@ndtsupply.com, www.ndtsupply.com



Product Information

Your serial number is located on the inside of the main door frame near the floor on the drivers side. The picture below illustrates the position of the serial number and the way it can be read.

The specific information of your lab is listed in the table below.



Serial # Location

**Month unit
manufactured**

**Year unit
manufactured**

Unit number

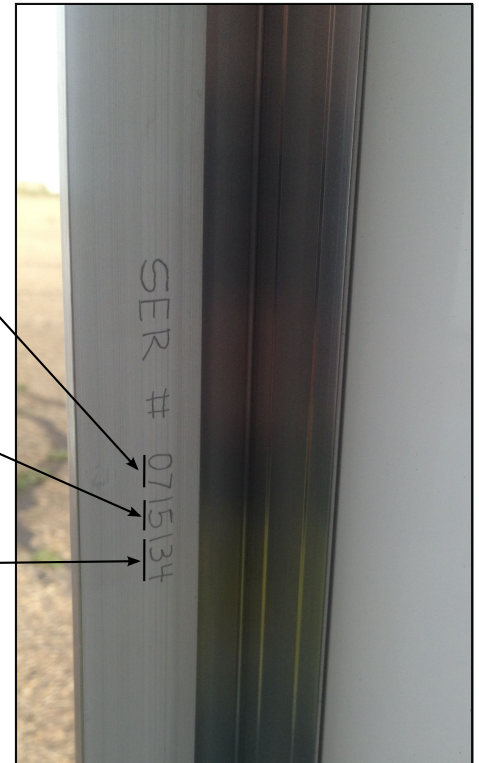

INFO

Note : Pictured serial number (above) is for reference only, your unit specific serial number is listed in the form below.

Serial Information	
Serial No :	
Company / Owner Name :	
Date Installed :	
Approval :	

LIFETIME STRUCTURAL WARRANTY

Armorlite Technologies uses the highest grade of materials and utilizes quality control measures that provide an extremely durable, long lasting product. These provide our customers with a worry free lifetime warranty.



What is covered

Defects in materials or workmanship for structure of unit, primary and secondary extrusions, corner caps, panel delamination, cracks and separations in outer structure of unit.

Duration of coverage

Warranty runs for the life of the product to the original purchaser.

What is not covered

Doors, hinges, latches, interior components, motors, blowers, heaters and cabinetry all of which are covered by our one year warranty protection against materials and workmanship. Paint peeling, flaking, fading and scratches not covered.

Conditions

- Damage caused by misuse, negligence, accidents, improper installation, acts of nature, or holes and openings not approved by manufacturer.
- Lack of maintenance or improper accessory installation not covered by any warranty whatsoever.
- Serial number defacement or alteration voids warranty.
- Manufacturer does not accept responsibility to purchaser for warranty expressed or implied by any of its dealers, agents or distributors.
- Incidental and consequential damages are expressly disclaimed.
- All fasteners and screws should be stainless steel, not zinc coated steel, to reduce galvanic corrosion which is not covered by warranty.
- All warranty repairs FOB Edmonton plant.

Armorlite reserves the right to accept or deny warranty at its own discretion.

Important Information

- Signs shall have sealed load spreading rivets and follow a minimum 4" increment from edge.
- Holes and mounting to be minimum 4" from all edges and shall be approved by Armorlite Technologies Inc.
- Locations during mounting of the unit(s) must be approved by Armorlite Technologies Inc.
- Replacement part(s) must be approved or manufactured by Armorlite Technologies Inc.
- Changes, modifications and add-ons to the electrical components in the unit(s) must be completed or approved by Armorlite Technologies. Failure to do so will cause the termination of this warranty.

Bolt Down Procedure

IMPORTANT INFORMATION

Condition 1. LOCATION DURING MOUNTING OF THE UNIT(S) MUST BE APPROVED BY ARMORLITE TECHNOLOGIES INC.

Condition 2. REPLACEMENT PART(S) APPROVED OR MANUFACTURED BY ARMORLITE TECHNOLOGIES INC

- 1) Determine lab positioning in truck box, mark desired bolt locations (4). Ensure bolts will not interfere with critical truck components and you have access to bottom side of bolts before drilling.
- 2) Drill 1/2" hole through lab floor and truck bed at marked locations (4).
- 3) Drill 7/8" holes through lab floor only, insert supplied crush sleeve (approx. .82" OD x .54" ID aluminum tube) into hole and bottom against floor of truck bed, ensure fully seated and mark sleeve at lab floor. Cut sleeve 1/32" to 1/16" LESS than mark to allow adequate clamping force without compressing floor excessively.
- 4) Install precut sleeves and 1/2" bolts with 3" (minimum) load spreading washers or plates on lab floor side. Use frame brackets bolted to vehicle sub frame. Use self locking nuts or lockwashers on bottom side.
- 5) Tighten bolts securely, inspecting floor for proper compression. Floor should NOT be compressed more than 1/16".

It is highly recommended to use frame brackets to attach lab to vehicle frame directly rather than box alone as under severe conditions lab can potentially pull through floor of truck box causing personal injury and/or property damage.

Notes:

Refer to figure 1.1 - 1.2 (on next page)

Length of sleeve depends on "valley" of truck bed floor. Upper rise or flat deck length of sleeve should be 2.160" +/- .080"

The length of "valley" in floor is determined by truck box and calculated using steps above.

Please use 1/2" schedule 80 aluminum pipe (0.82"OD x 0.54"ID) as crush sleeve material.

Bolt Down Procedure

Crush sleeves MUST be used to prevent damaging core structure of floor. Warranty will NOT cover damage caused by improper mounting procedures.

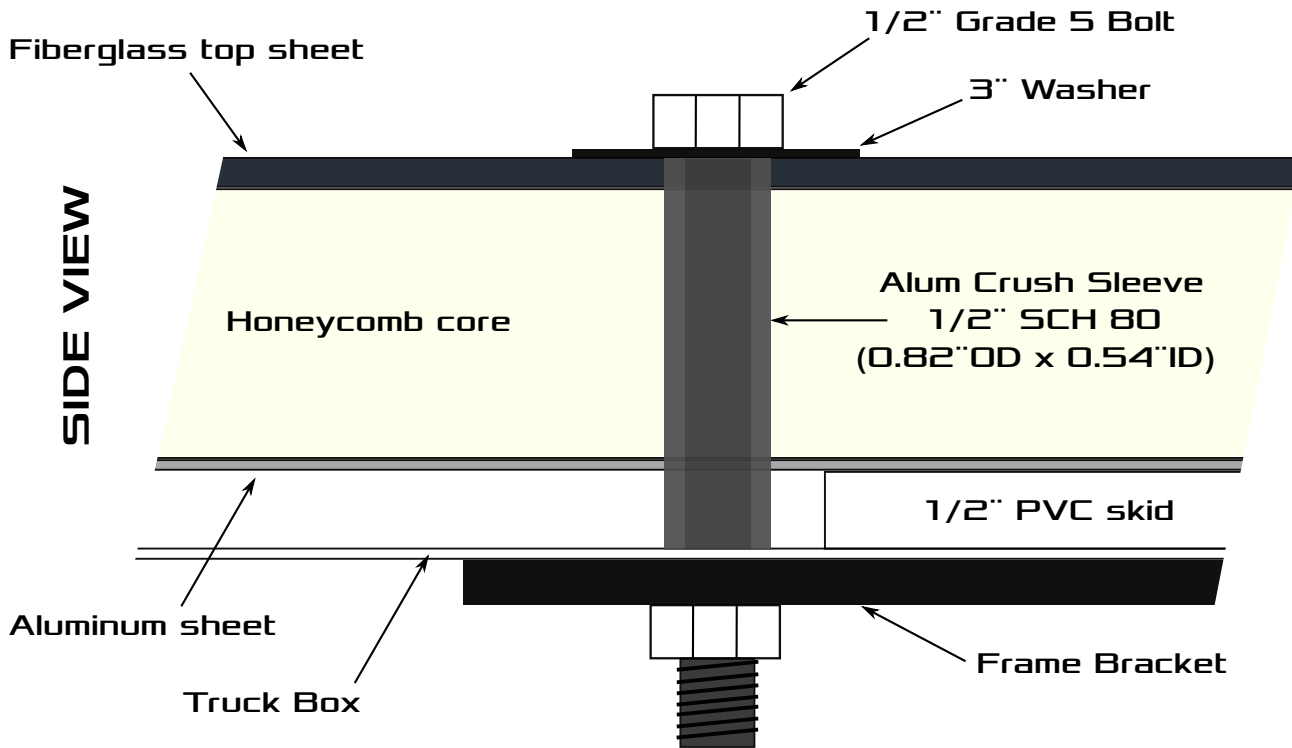

figure 1.1

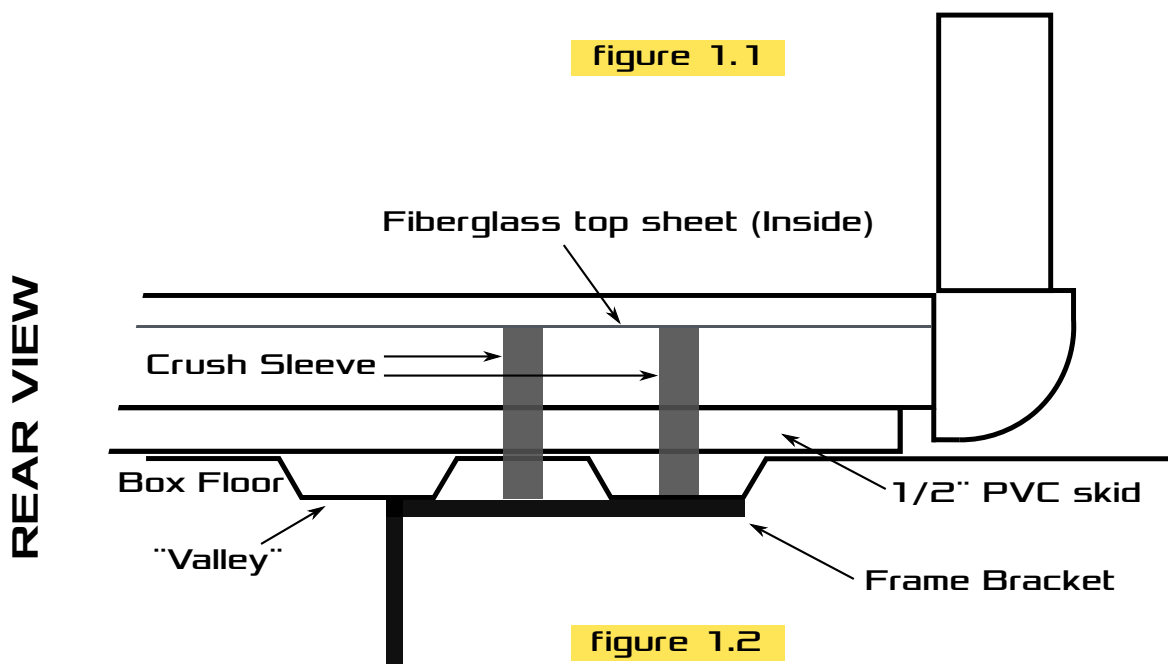
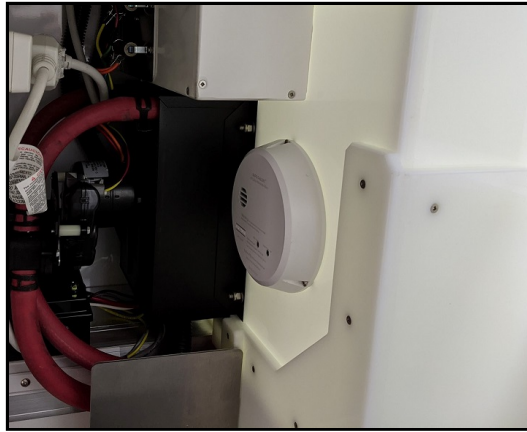

figure 1.2

INSTALL

Electrical

C/O MONITOR



Your unit has been equipped with a lifetime battery carbon monoxide monitor for your safety. Periodic testing of the unit and ensuring proper operation protects against harmful and potentially fatal carbon monoxide poisoning. Do NOT disable or remove this safety device. If there is an issue with the unit please contact Armorlite Technologies Inc directly for diagnosis/repair or replacement. The battery in this unit is designed to operate in all weather conditions and is rated for the lifespan of the unit.

120 VAC BREAKER



Your unit is also fitted with a 120 VAC breaker to protect the wiring inside the lab from high current damage. The breaker is found mounted to the side of the black electrical box (under the main bench). If the breaker trips it can be reset by depressing the white button on the side of the electrical box. The box does NOT need to be opened to reset the breaker.

When supplying external 120VAC power to unit, electrical cord and outlet must have functioning ground connections present.

Electrical



LEGEND

- S/L - Safe Light (adjustable)
- HTR - 12v Heater
- EXH - Exhaust Fan
- INT - Intake Fan
- AUX - Optional Switch
- W/L - White Light

→ Dryer Temperature Control

ELECTRICAL

→ 12VDC Jacks

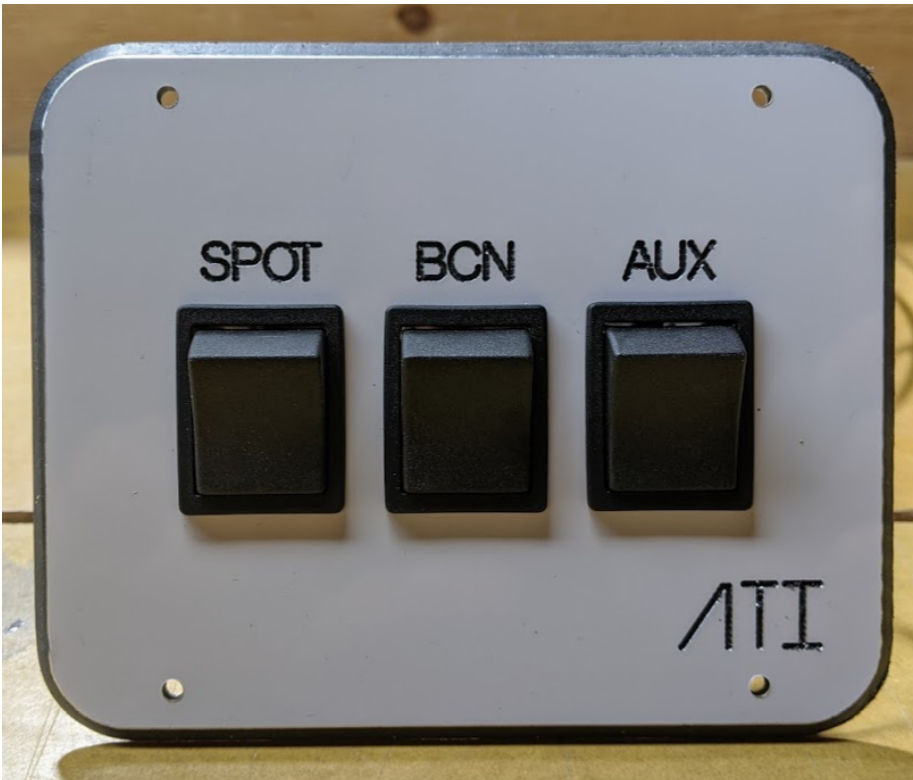

LEGEND

- SPOT - Spot Light
- BCN - Beacon
- AUX - Optional Switch

Electrical

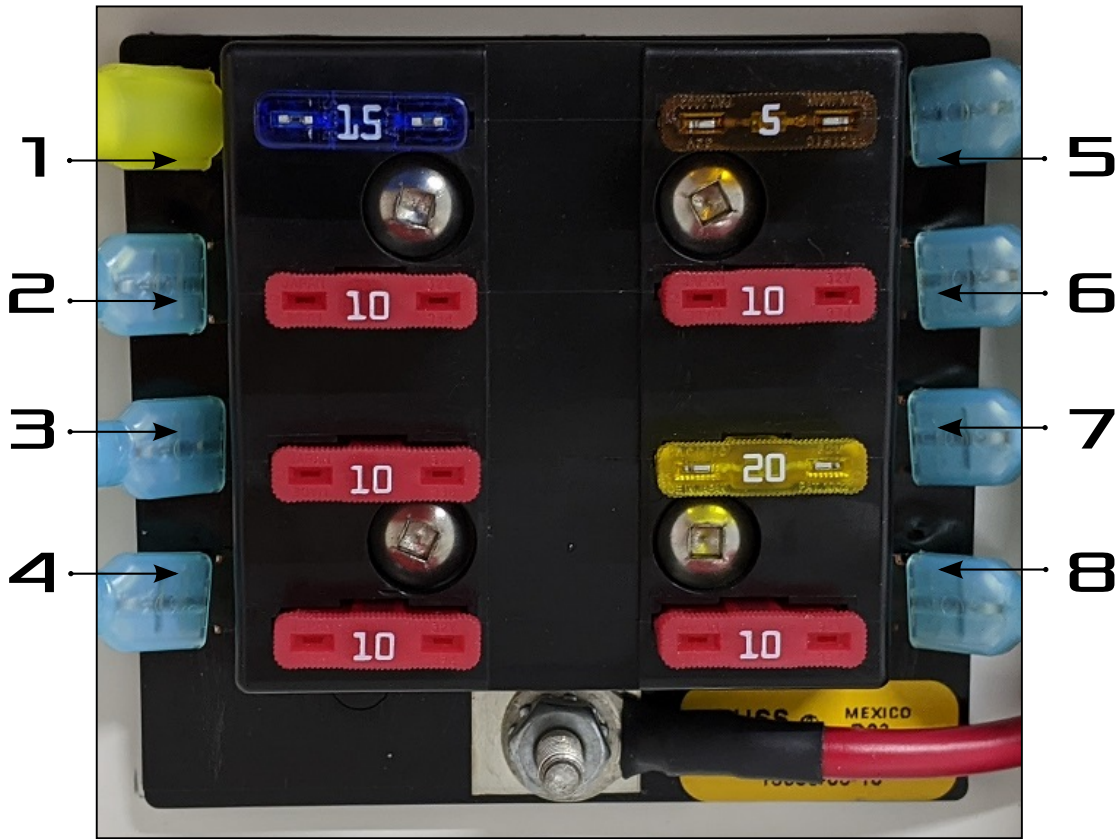

FUSE LOCATION

- | | |
|----------------------------|---------------------------------------|
| 1. - 15A 12v Jacks | 5. - 5A White Light Safe Light |
| 2. - 10A Intake Fan | 6. - 10A Heater Valve |
| 3. - 10A Heater | 7. - 20A USB / 12VDC |
| 4. - 10A Aux Panel | 8. - 10A Exhaust Fan |

ELECTRICAL

Electrical

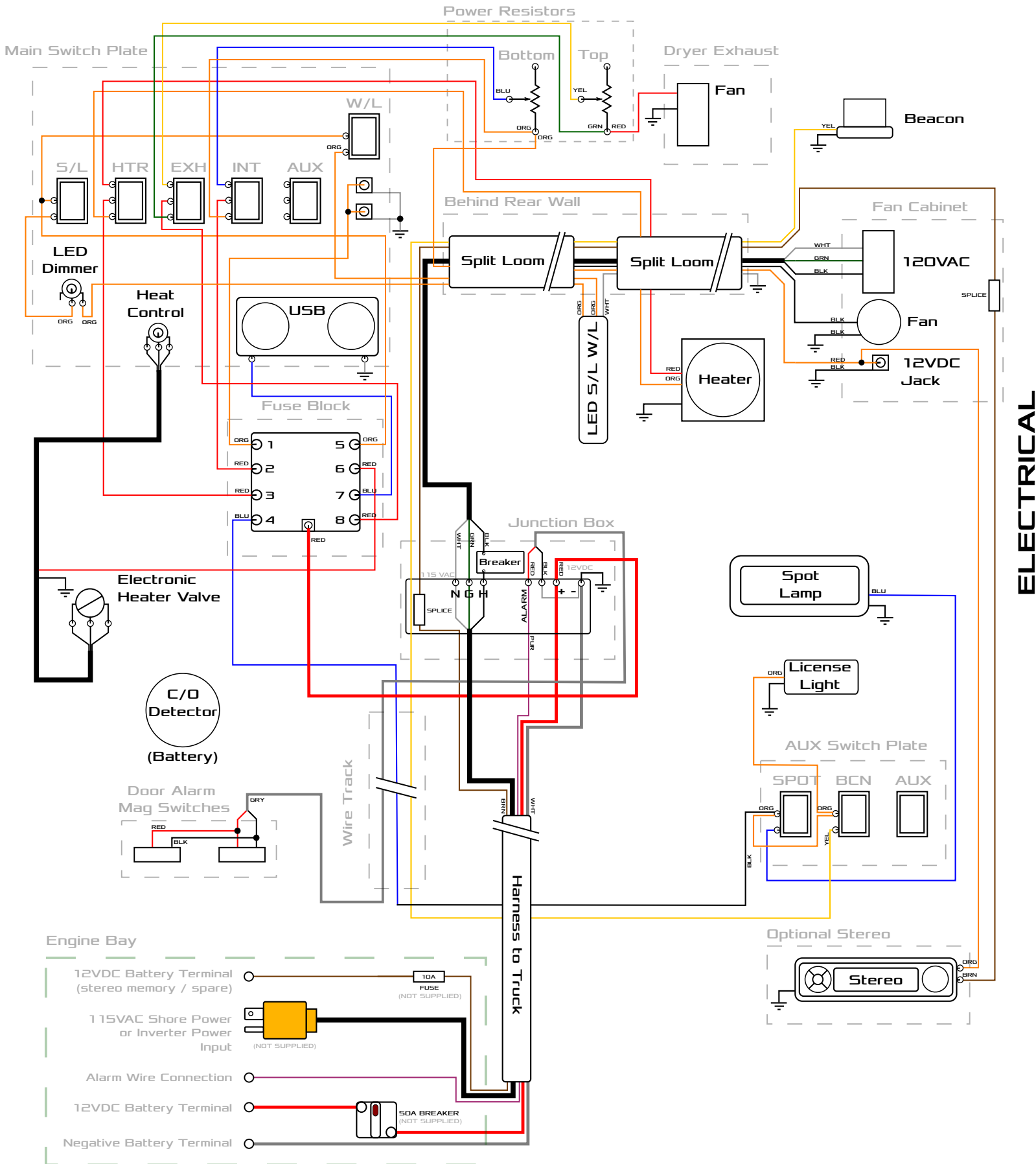

ELECTRICAL

Plumbing

Your unit is equipped with 1 manual shutoff valve and an automatic "smart" valve for controlling coolant flow to the heater and chill chaser. The manual valve is located next to the chill chaser and the smart valve is next to the heater (pictured below). Moving either to the open or closed position will allow temperature regulation to the heater or chill chaser.

The smart valve is controlled via the temperature dial on the switch plate, this will vary the amount of coolant flowing to the dryer heater allowing for full temperature control.

The plumbing system has been built from solid copper and attached to the unit with CNC cut mounting brackets for zero maintenance and long term reliability.



Chill chaser valve shown in the open position

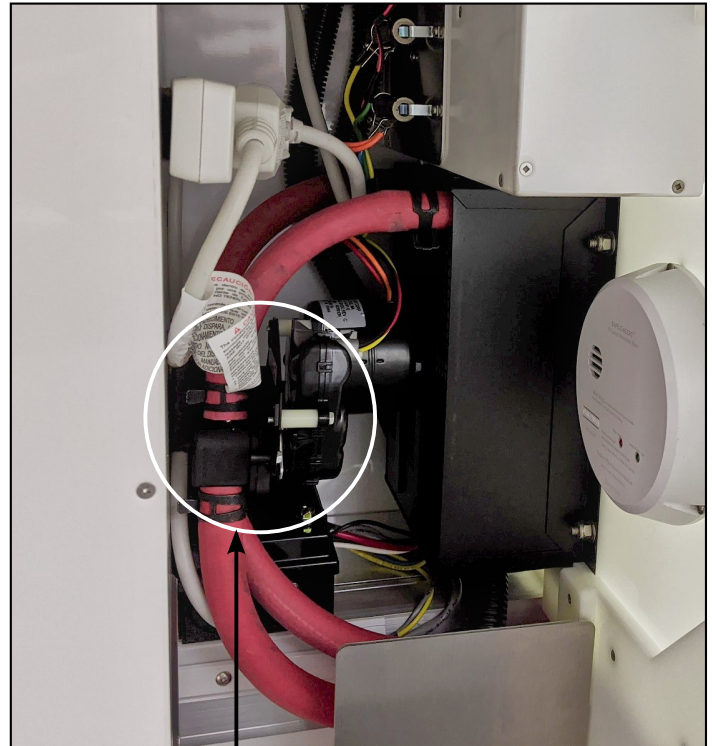

Location of "smart" heater valve (electronic control)

PLUMBING

Dryer Operation

Your lab is specifically equipped with both a passive and active air ventilation system. The intake fan will pressurize the unit and force air through the dryer. If additional airflow is required the exhaust fan will boost this effect and increase the airflow through the dryer.

- Turning heater on "low" forces moist air out of the dryer while getting its replacement air from the intake vents.
- Turning the heater on "high" provides the same operation with increased airflow.
- Turning on the exhaust fan will further increase airflow. Using this in combination with the 12VDC heater will produce faster forced drying and should be adjusted to suit operators needs / requirements.
- Temperature regulation is controlled using the smart heater control. Adjusting this dial changes the temperature of air going into the dryer.

**Exhaust Outlet
(Inside Dryer)**



**Drain Outlets
(Inside Dryer)**

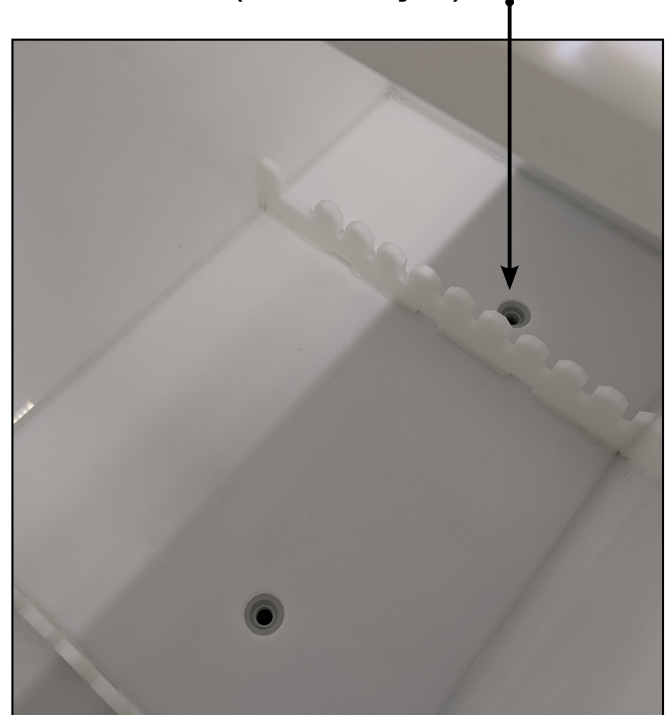

PLUMBING

Care and Maintenance

IMPORTANT INFORMATION

Many cleaning products/agents can be potentially hazardous; some may be poisonous and flammable. Always follow the instructions on the container. Please allow for proper ventilation when cleaning the interior. Never use fluids or solvents that are not designed for cleaning. Always lock away cleaning products and keep them out of reach of children.

Maintenance

- Wash all spilled chemicals off of unit surfaces (walls/floors) with clean water as soon as practical.
- Silicone or teflon spray all door lock cylinders, rotary latches, etc. to prevent corrosion and extend life.
- Door hinges should be oiled periodically to aid in smooth operation and extend service life.
- The latching position of the main door rotary can be adjusted via the access hole in the door side. This adjustment sets the release travel of the main door handle.

General cleaning

- Use a clean soft bristle brush or cloth to clean exterior.
- Use a mild cleaning agent.
- Rinse the unit with clean water and dry thoroughly with a dry microfiber cloth.
- Do not allow cleaning agent(s) to dry on the exterior/interior surfaces.
- When using the unit in winter remove all traces of road salt deposits carefully and as soon as practical.
- Applying automotive wax annually will greatly improve longevity of painted surfaces, keep unit cleaner and prevent staining (highly recommended).
- Remove dirt as soon as practical, when possible avoid scrubbing with force.
- After extended road trips in adverse conditions, the rear of the lab is exposed to excessive up-spray causing corrosion to form if not removed.

Specifications

Long Box Specs
Height - 64"
Width - 60"
Length - 99"
Int Height - 60"
Int Width - 56"
Int Length - 93"
Weight - 915 lbs

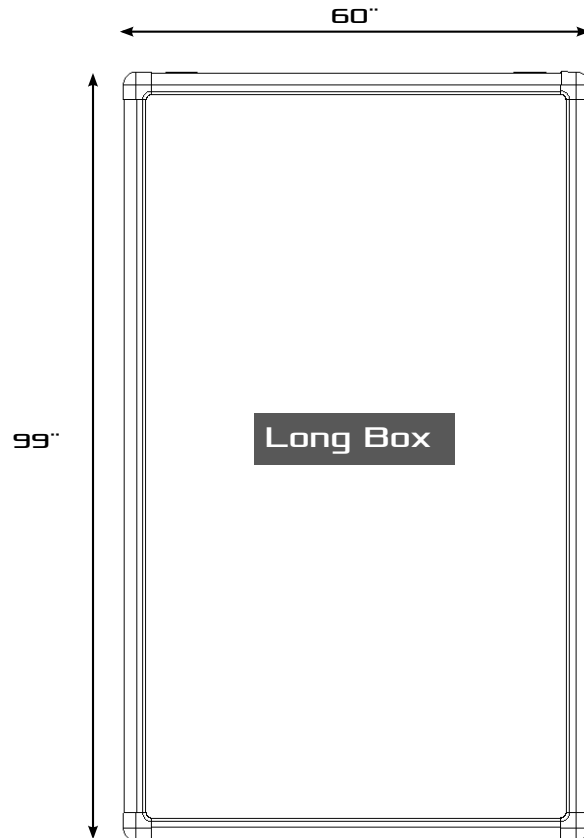
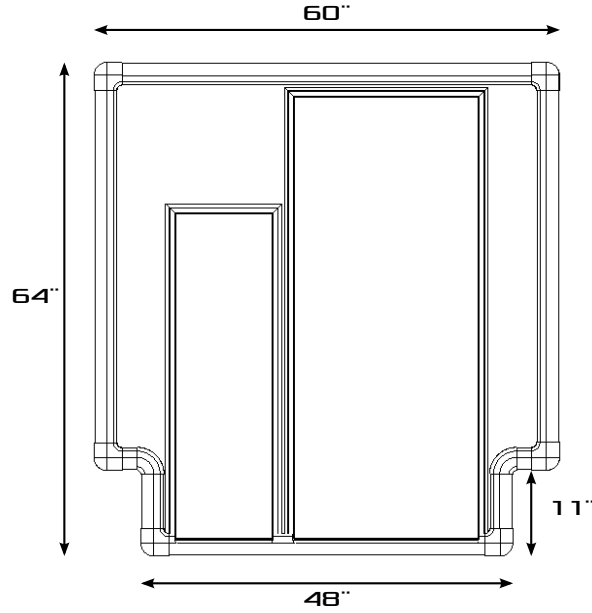

INFO

Replacement Parts

Description	Part No.
Bulb Weather Strip _____	6234478
T-Handles _____	6970453
Beacon Light _____	STB-A34
Interior LED Light _____	ATI-LEDRT
Switch ST/DP _____	EG 1524-ND
Switch DT/DP _____	EG 1539-ND
12VDC Jacks _____	SC 1317-ND
Ball Valve _____	0541133
Cabinet Latches _____	634-30
Intake Blower _____	1688-1378-ND
Heater Hose 5/8" _____	GYR65025
12VDC Heater _____	ED-R254-OP
CO Detector _____	1042-7

INFO

ALL FASTENERS AND SCREWS SHOULD BE STAINLESS STEEL NOT ZINC COATED STEEL TO REDUCE GALVANIC CORROSION WHICH IS NOT COVERED BY WARRANTY.

NDT Supply.com, Inc.

7952 Nieman Road
Lenexa, KS 66214-1560 USA

Phone: 913-685-0675, Fax: 913-685-1125
e-mail: sales@ndtsupply.com, www.ndtsupply.com

