



TRANSDUCERS

| SINGLE ELEMENT CONTACT TRANSDUCERS (SLM) – HIGH WEAR | | | | |
|---|---|-----------------|--|----------------|
|  | | | | |
| Element Size (Dia.) | A | B |  | |
| .500" | 1.055" | 1.230" | | |
| .750" | 1.268" | 1.430" | | |
| 1.00" | 1.555" | 1.430" | | |
| Description: | High wear/resolution contact transducers with extended stainless steel ring. | | | |
| Used: | Rough surfaces, Castings, Billets, and Extruded Parts. | | | |
| Damping: | Medium | | | |
| Connectors: | BNC (B), Lemo 1 (L) *Specify connector type after part # | | | |
| Price: | \$325.00 US **\$415.00 or ***\$385.00 (P) Composite option – 1MHz & 3.5MHz only available with Composite. ***Call for price on 3.5MHz. | | | |
| Element Size | **1.0 MHz | 2.25 MHz | ***3.5 MHz | 5.0 MHz |
| .500" DIA. (a) | PSLM501 | SLM5025 | PSLM5035 | SLM5050 |
| .750" DIA. | PSLM751 | SLM7525 | PSLM7535 | SLM7550 |
| 1.00" DIA. | PSLM101 | SLM1025 | PSLM1035 | SLM1050 |
| Ordering Example: SLM7525B = SLM .750" x 2.25MHz BNC | | | | |

| SINGLE ELEMENT CONTACT TRANSDUCERS (SLF) – MEMBRANE | | | | |
|--|----------|----------|--|--|
|  | | | | |
| Element Size (Dia.) | A | B |  | |
| .500" | 1.250" | 1.180" | | |
| 1.00" | 1.500" | 1.580" | | |

NDT Supply.com, Inc.

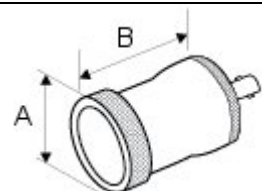
7952 Nieman Road
Lenexa, KS 66214-1560 USA

Phone: 913-685-0675, Fax: 913-685-1125
e-mail: sales@ndtsupply.com, www.ndtsupply.com



| | | | | |
|--|---|--------------------|------------------|-------------------|
| Description: | Replaceable membrane protected contact transducers. | | | |
| Used: | Rough surfaces, Castings (provides better contact). | | | |
| Damping: | High Gain | | | |
| Connectors: | BNC | | | |
| Price: | \$360.00 US **\$425.00 (P) Composite option - 1MHz & 3.5MHz only available with Composite. ***\$400.00 (P) Composite option. | | | |
| Element Size | **1.0 MHz | ***2.25 MHz | **3.5 MHz | ***5.0 MHz |
| .500" DIA. | PSLF501 | SLF5025 | PSLF5035 | SLF5050 |
| 1.00" DIA. | PSLF101 | SLF1025 | PSLF1035 | SLF1050 |
| Ordering Example: SLF101 = SLF 1.00" x 1.0 MHz | | | | |

SINGLE ELEMENT CONTACT TRANSDUCERS (FC) – FINGER TIP



| | | | | | |
|--|--|-----------------|----------------|----------------|-------------------|
| Description: | General contact style transducers with stainless steel construction. Good for near surface resolution with a 70% bandwidth. | | | | |
| Used: | Common metals, plastics | | | | |
| Damping: | High gain (G), Resolution (R) *Specify damping after (FC), No Damping on 1MHz or 3.5MHz - Composite. | | | | |
| Connectors: | Microdot Side Entry *Optional top connect (T) | | | | |
| Price: | \$320.00 US or **\$385.00. 1MHz & 3.5MHz only available with Composite. \$360.00 (P) Composite option. *Specify connector mount after part # | | | | |
| Element Size | 1.0 MHz | 2.25 MHz | 3.5 MHz | 5.0 MHz | **10.0 MHz |
| .250" DIA. | - | FC2525 | PFC2535 | FC2550 | FC2510 |
| .375" DIA. | - | FC3725 | PFC3735 | FC3750 | FC3710 |
| .500" DIA. | PFC501 | FC5025 | PFC5035 | FC5050 | FC5010 |
| Ordering Example: FCR5025T = FC Resolution .500" x 2.25MHz TOP MOUNT | | | | | |

SINGLE ELEMENT CONTACT TRANSDUCERS (FCSL) – FINGER TIP (SLIM LINE)



| | |
|---------------------|---|
| Description: | Line high frequency general contact transducers with a stainless steel housing. |
| Used: | Common metals, plastics |

| | | | | |
|--|---|-----------------|-----------------|-----------------|
| Damping: | High Damped | | | |
| Connectors: | Microdot Side Entry *Optional top connect (T), Specify after part # | | | |
| Price: | See below | | | |
| Element Size | 5.0 MHz | 10.0 MHz | 15.0 MHz | 20.0 MHz |
| Price | \$365 | \$390 | - | - |
| .125" DIA. | FCSL1250 | FCSL1210 | FCSL1215 | FCSL1220 |
| Ordering Example: FCSL1250T = FCSL .125" x 5MHz w/top entry microdot | | | | |

STANDARD SHEAR WAVE TRANSDUCERS (SS)



| Element Size (Dia.) | A | B | C | D |
|---------------------|-------|-------|--------|--------|
| .500" x .500" | .650" | .750" | 1.125" | .810" |
| .500" x 1.00" | .650" | .750" | 1.625" | 1.312" |
| .625" x .625" | .650" | .850" | 1.350" | 1.000" |
| .750" x .625" | .650" | .850" | 1.350" | 1.000" |
| .750" x .750" | .650" | .910" | 1.350" | 1.000" |

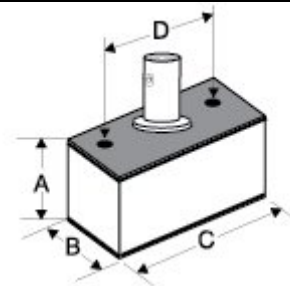

| | | | |
|---|---|----------------------|----------------------|
| Description: | Shear wave transducers designed to use a variety of angle beam wedges for general weld inspection & A.W.S, and constructed in a low noise plastic or stainless steel housing. | | |
| Used: | General weld inspection. | | |
| Damping: | High gain (G), Resolution (R) *Specify damping after (SS), No damping on 1MHz - Composite. | | |
| Connectors: | BNC (B), Microdot (M) *Specify connector after part # | | |
| Price: | \$320.00 US **355.00 (P) Composite (2.25MHz AWS) | | |
| Element Size | **1.0 MHz | 2.25 MHz | 5.0 MHz |
| .500" x .500" | PSS50501 | SS50502 | SS50505 |
| .500" x 1.00" | PSS50101 | SS50102 | SS50105 |
| .625" x .625" | PSS62621 | **PSS62622 / SS62622 | **PSS62625 / SS62625 |
| .625" x .750" | PSS62751 | **PSS62752 / SS62752 | **PSS62755 / SS62755 |
| .750" x .750" | PSS75751 | SS75752 | SS75755 |
| Ordering Example: SSG50502 = SS High Gain 1/2" x 1/2" 2.25MHz | | | |

NDT Supply.com, Inc.

7952 Nieman Road
Lenexa, KS 66214-1560 USA

Phone: 913-685-0675, Fax: 913-685-1125
e-mail: sales@ndtsupply.com, www.ndtsupply.com



STANDARD WEDGES (SW)



Price: \$42.50 US

Angle Beam Wedges – Custom angles available on request.

| Element Size | 45° | 60° | 70° |
|---------------|--------|--------|--------|
| .500" x .500" | SW5045 | SW5060 | SW5070 |
| .500" x 1.00" | SW5145 | SW5160 | SW5170 |
| .625" x .625" | SW6245 | SW6260 | SW6270 |

Note: An additional \$10 will be charged to radius edges.

Ordering Example: SW5045 = SW 1/2" x 1/2" 45 Degree steel

SERRATED (AWS TYPE) SQUARE WEDGES (SQW)



Price: \$52.50 US

Angle Beam Wedges – Custom angles & radius available on request.

| Element Size | 45° | 60° | 70° |
|---------------|---------|---------|---------|
| .625" x .625" | SQW6245 | SQW6260 | SQW6270 |
| .625" x .750" | SQW6245 | SQW6260 | SQW6270 |

Note: An additional \$10 will be charged to radius edges.

Ordering Example: SQW6245 = SQW 5/8" x 5/8" 45 Degree steel

SNAIL (AWS TYPE) WEDGES (SNW)



Price: \$52.50 US

NDT Supply.com, Inc.

7952 Nieman Road
Lenexa, KS 66214-1560 USA

Phone: 913-685-0675, Fax: 913-685-1125
e-mail: sales@ndtsupply.com, www.ndtsupply.com



| | | | |
|---|------------|------------|------------|
| Angle Beam Wedges – Custom angles & radius available on request. | | | |
| Element Size | 45° | 60° | 70° |
| .625" x .625" | SNW6245 | SNW6260 | SNW6270 |
| Note: An additional \$10 will be charged to radius edges. | | | |
| Ordering Example: SNW6245 = SNW 5/8" x 5/8" 45 Degree steel | | | |

QUICK CHANGE SHEAR WAVE TRANSDUCERS (QC)



| | |
|---------------------|---|
| Description: | Threaded shear wave transducers for quickly interchanging between wedges. Ideal for limited access and curved surfaces. |
| Used: | General weld inspection |
| Damping: | High gain (G), Resolution (R) *Specify damping after (QC), No damping on 3.5MHz |
| Connectors: | Microdot |
| Price: | \$320.00 **\$340.00 US |

| | | | | | |
|---------------------|----------------|-----------------|----------------|----------------|-------------------|
| Standard (Q) | | | | | |
| Element Size | 1.0 MHz | 2.25 MHz | 3.5 MHz | 5.0 MHz | **10.0 MHz |
| .250" DIA. | - | QC2525 | - | QC2550 | QC2510 |
| .375" DIA. | - | QC3725 | - | QC3750 | QC3710 |
| .500" DIA. | - | QC5025 | - | QC5050 | QC5010 |

Ordering Example: QCR2510 = QC Resolution .250" x 10MHz

| | |
|---------------|--------------------|
| Price: | \$340.00 US |
|---------------|--------------------|

| | | | | | |
|----------------------|----------------|-----------------|----------------|----------------|-----------------|
| Composite (P) | | | | | |
| Element Size | 1.0 MHz | 2.25 MHz | 3.5 MHz | 5.0 MHz | 10.0 MHz |
| .250" DIA. | PQC251 | PQC2525 | - | PQC2550 | PQC2510 |
| .375" DIA. | PQC371 | PQC3725 | - | PQC3750 | |
| .500" DIA. | PQC501 | PQC5025 | PQC5035 | PQC5050 | |

Ordering Example: PQC2510 = QC Composite .250" x 10MHz

NDT Supply.com, Inc.

7952 Nieman Road
Lenexa, KS 66214-1560 USA

Phone: 913-685-0675, Fax: 913-685-1125
e-mail: sales@ndtsupply.com, www.ndtsupply.com



STANDARD QUICK CHANGE WEDGES (QW)



Price: \$42.50 US

Quick Change Wedges – Custom angles available on request.

| Element Size | 45° | 60° | 70° |
|--------------|--------|--------|--------|
| .250" DIA. | QW2545 | QW2560 | QW2570 |
| .375" DIA. | QW3745 | QW3760 | QW3770 |
| .500" DIA. | QW5045 | QW5060 | QW5070 |

Ordering Example: QW2545 = QW .250" 45 Degree

QUICK CHANGE AWS PROVE UP SHEAR WAVE TRANSDUCERS (QCA)



Description: Removable shear wave transducers for quickly interchanging between wedges. Ideal for limited access, curved surfaces, and AWS prove up.

Used: General weld inspection

Damping: High Damped

Connectors: Microdot

Price: \$385.00 **\$425 US ***AWS

| Element Size | **1.0 MHz | ***2.25 MHz | 5.0 MHz |
|---------------|-----------|-------------|----------|
| .625" x .625" | PQCA62621 | QCA62622 | QCA62625 |

Ordering Example: QCA62622 = QCA .625" x .625" 2.25MHz Microdot

NDT Supply.com, Inc.

7952 Nieman Road
Lenexa, KS 66214-1560 USA

Phone: 913-685-0675, Fax: 913-685-1125
e-mail: sales@ndtsupply.com, www.ndtsupply.com



QUICK CHANGE AWS PROVE UP WEDGES (QAW)



Price: \$52.50 US

Angle Beam Wedges – Custom angles & radius available on request.

| Element Size | 45° | 60° | 70° |
|---------------|---------|---------|---------|
| .625" x .625" | QAW6245 | QAW6260 | QAW6270 |

Note: An additional \$10 will be charged to radius edges.

Ordering Example: QAW6245 = SNW 5/8" x 5/8" 45 Degree Steel

DUAL SHEAR WAVE TRANSDUCERS (CDA)



Description: Designed for thin material and weld inspections that require near surface resolution. Will Detect of IGSCC (Inter Granular Stress Corrosion Cracking).

Used: Weld inspection

Damping: Medium Damped

Connectors: Microdot End (E) or Top (T) connect *Specify after part #

Price: \$575.00 US **625.00 (P) Composite option – 1MHz only available with Composite.

| Element Size | **1.0 MHz | 2.25 MHz | 5.0 MHz |
|---------------|-----------|-----------|-----------|
| .250" x .250" | PCDA251 | CDA2525 | CDA2550 |
| .250" x .375" | PCDA25371 | CDA253725 | CDA253750 |
| .375" x .375" | PCDA371 | CDA3725 | CDA3750 |
| .500" x .500" | PCDA501 | CDA5025 | CDA5050 |

Ordering Example: CDA252560T = CDA 1/4" x 1/4" 2.25 MHz, 60 Degree Top Connector.

CDA ANGLE OPTIONS – NOT INTERCHANGEABLE

| Element Size | 45° | 60° | 70° |
|--------------|-----|-----|-----|
|--------------|-----|-----|-----|

NDT Supply.com, Inc.

7952 Nieman Road
Lenexa, KS 66214-1560 USA

Phone: 913-685-0675, Fax: 913-685-1125
e-mail: sales@ndtsupply.com, www.ndtsupply.com



| | | | |
|-----|---------------|---------------|---------------|
| ALL | ADD 45 TO PT# | ADD 60 TO PT# | ADD 70 TO PT# |
|-----|---------------|---------------|---------------|

MINIATURE ANGLE BEAM POTTED (MAP)



| | |
|---------------------|--|
| Description: | Mini angle beam transducers with a fixed angle. Stainless steel Housing, all angles are in steel, aluminum angle available on request. |
| Used: | Weld inspection (tight areas). |
| Damping: | Medium Damped |
| Connectors: | Microdot Side Entry |
| Price: | \$315.00 US **\$335.00 US |

| Element Size | 2.25 MHz | | | 5.0 MHz | | |
|----------------------|---------------|---------------|---------------|---------------|---------------|---------------|
| | 45° | 60° | 70° | 45° | 60° | 70° |
| .187" DIA. | MAP 182545 | MAP 182560 | MAP 182570 | MAP 185045 | MAP 185060 | MAP 185070 |
| .250" DIA. | MAP 252545 | MAP 252560 | MAP 252570 | MAP 255045 | MAP 255060 | MAP 255070 |
| ** .375" DIA. | MAP 372545 | MAP 372560 | MAP 372570 | MAP 375045 | MAP 375060 | MAP 375070 |

| Element Size | **10.0 MHz | | |
|-------------------|-------------------|---------------|---------------|
| | 45° | 60° | 70° |
| .187" DIA. | MAP 181045 | MAP 181060 | MAP 181070 |
| .250" DIA. | MAP 251045 | MAP 251060 | MAP 251070 |
| .375" DIA. | MAP 371045 | MAP 371060 | MAP 371070 |

MINI MINIATURE ANGLE BEAM POTTED (MMAP) – DIM .375" L x .250" W x .37" H



| | |
|---------------------|---|
| Description: | Mini miniature angle beam potted transducers with a fixed angle, are designed with stainless steel Housing for durability. Standard angles are in steel, all other non-standard angles with specific materials can be produced. |
| Used: | Weld inspection (tight areas). |
| Damping: | Medium Damped |
| Connectors: | Microdot Side Entry |
| Price: | \$420.00 US **\$445.00 US |

NDT Supply.com, Inc.

7952 Nieman Road
Lenexa, KS 66214-1560 USA

Phone: 913-685-0675, Fax: 913-685-1125

e-mail: sales@ndtsupply.com, www.ndtsupply.com



| Element Size | 5.0 MHz | | | **10.0 MHz | | |
|--------------|----------------|----------------|----------------|----------------|----------------|----------------|
| | 45° | 60° | 70° | 45° | 60° | 70° |
| .187" DIA. | MMAP 185045 | MMAP 185060 | MMAP 185070 | MMAP 181045 | MMAP 181060 | MMAP 181070 |

IMMERSION TRANSDUCERS (IM)



| Element Size (Dia.) | A | B | C | D |
|---------------------|-------------|-------|-------|---|
| .250" | Custom Only | | | |
| .375" | 1.75" | 1.40" | .525" | |
| .500" | 1.75" | 1.40" | .625" | |
| .750" | 1.75" | 1.00" | 1.00" | |

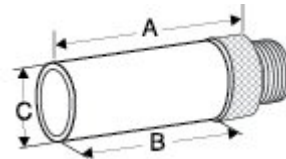

| | |
|--|---|
| Description: | Designed for immersion tank or bubbler system inspections. Stainless steel housing with UHF connector. Three different lens configurations are available – Flat, Spherical focus and Cylindrical focus. |
| Used: | Immersion and bubbler inspections |
| Damping: | High Gain (G), Resolution (R), and High Resolution (HR), No damping on 1MHz (P) Composite Option Only. |
| Connectors: | UHF |
| Price: | \$315.00 US **\$340 US ***\$420.00 Add: \$50.00 for focusing (HR) |
| Note: Specify damping after (IM), Lens configuration, or focal length when placing order. | |
| Note: Higher frequencies available upon request. | |

| Element Size | 1.0 MHz | 2.25 MHz | 5.0 MHz | **10.0 MHz | ***15.0 MHz |
|--------------|----------------------|----------|---------|------------|-------------|
| .250" DIA. | - | IM2525 | IM2550 | IM2510 | IM2515 |
| .375" DIA. | - | IM3725 | IM3750 | IM3710 | - |
| .500" DIA. | PIM501 (\$370.00) | IM5025 | IM5050 | IM5010 | - |
| .750" DIA. | PIM751 (\$395.00) | IM7525 | IM7550 | IM7510 | - |
| 1.00" DIA. | PIM101 (\$420.00) | IM1025 | IM1050 | - | - |

Ordering Example: IMR7550 = IM Resolution .750" 5MHz

Thickness Gauge Transducers

| | |
|-----------------------------|--|
| Dual Element: | All thickness gauge transducers are compatible with our flaw detectors. Refer to the thickness gauge transducer catalog for additional information on available diameters, frequencies, and connector types. |
| Delay Line: | Same as above |
| Pencil (Delay line): | Same as above |

NDT Supply.com, Inc.

7952 Nieman Road
Lenexa, KS 66214-1560 USA

Phone: 913-685-0675, Fax: 913-685-1125
e-mail: sales@ndtsupply.com, www.ndtsupply.com



Dual Element Transducers



**Refer to the thickness gauge price sheet for additional information and pricing.

Delay Line & Pencil Transducers



**Refer to the thickness gauge price sheet for additional information and pricing.

NDT Supply.com, Inc.

7952 Nieman Road
Lenexa, KS 66214-1560 USA

Phone: 913-685-0675, Fax: 913-685-1125
e-mail: sales@ndtsupply.com, www.ndtsupply.com

