

North American Standard - N5

- Low height probes, suitable for narrow and limited detection environments
- Lemo 00(C5) Side Mounting Connector, with handle bar

Frequency MHz	Diameter		Specification		
	mm	in	PL	PH	C
1	13	0.50	N5-1P13	N5-1P13-H	N5-1C13
	19	0.75	N5-1P19	N5-1P19-H	/
	25	1.00	N5-1P25	N5-1P25-H	/
2.25	6	0.25	N5-2.25P6	N5-2.25P6-H	N5-2.25C6
	10	0.375	N5-2.25P10	N5-2.25P10-H	N5-2.25C10
	13	0.50	N5-2.25P13	N5-2.25P13-H	N5-2.25C13
	19	0.75	N5-2.25P19	N5-2.25P19-H	/
3.5	25	1.00	N5-2.25P25	N5-2.25P25-H	/
	6	0.25	N5-3.5P6	N5-3.5P6-H	N5-3.5C6
	10	0.375	N5-3.5P10	N5-3.5P10-H	N5-3.5C10
	13	0.50	N5-3.5P13	N5-3.5P13-H	/
5	19	0.75	N5-3.5P19	N5-3.5P19-H	/
	25	1.00	N5-3.5P25	N5-3.5P25-H	/
	6	0.25	N5-5P6	N5-5P6-H	N5-5C6
	10	0.375	N5-5P10	N5-5P10-H	N5-5C10
7.5	13	0.50	N5-5P13	N5-5P13-H	/
	19	0.75	N5-5P19	N5-5P19-H	/
	6	0.25	N5-7.5P6	N5-7.5P6-H	/
10	10	0.375	N5-7.5P10	N5-7.5P10-H	/
	13	0.50	N5-7.5P13	N5-7.5P13-H	/
	6	0.25	N5-10P6	N5-10P6-H	/
15	10	0.375	N5-10P10	N5-10P10-H	/
	13	0.50	N5-10P13	N5-10P13-H	/
	3	0.125	/	N5-15P3-H	/
20	6	0.375	/	N5-15P6-H	/
	3	0.125	/	N5-20P3-H	/
25	3	0.125	/	N5-25P3-H	/

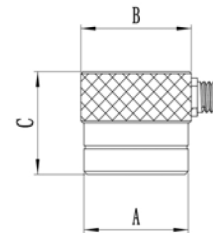

Specification		Dimensions					
		A		B		C	
mm	in	mm	in	mm	in	mm	in
3	0.125	6.5	0.26	7.5	0.3	10	0.4
6	0.25	9	0.35	10.5	0.41	13	0.51
10	0.375	14	0.55	15	0.59	14	0.55
13	0.50	17	0.66	18	0.71	16	0.64
19	0.75	24	0.95	25	0.97	16	0.64
25	1.00	29	1.15	30	1.18	16	0.64