

North American Standard - I2

- Top Mounting UHF waterproof connector

Dimensions							
Probe Specification		A		B		C	
mm	in	mm	in	mm	in	m	in
19	0.75	25	1.00	27	1.06	32	1.25
25	1.00	32	1.25	33	1.31	32	1.25
29	1.125	35	1.38	37	1.44	32	1.25

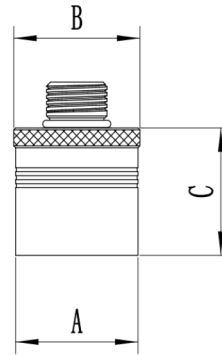

Dimensions	
Probe Specification	
mm	in
3	0.13
6	0.25

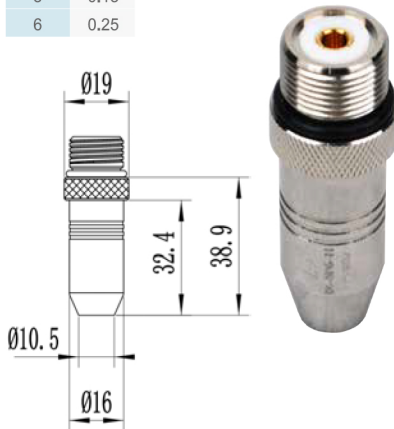

Dimensions	
Probe Specification	
mm	in
10	0.38
13	0.50



Frequency	Diameter		Probe Specification			Focal Range			
			Models			Min		Max	
			PL	PH	C	mm	in	mm	in
0.5	19	0.75	/	I2-0.5P19-H	I2-0.5C19	25	0.98	25	0.98
	25	1.00	I2-0.5P25	I2-0.5P25-H	I2-0.5C25	35	1.38	42	1.65
	29	1.125	/	I2-0.5P29-H	/	40	1.57	52	2.05
1	13	0.50	I2-1P13	I2-1P13-H	I2-1C13	16	0.63	20	0.79
	19	0.75	I2-1P19	I2-1P19-H	I2-1C19	30	1.18	45	1.77
	25	1.00	I2-1P25	I2-1P25-H	I2-1C25	48	1.89	75	2.95
2.25	29	1.125	I2-1P29	I2-1P29-H	/	55	2.17	90	3.54
	6	0.25	I2-2.25P6	I2-2.25P6-H	I2-2.25C6	10	0.39	12	0.47
	10	0.375	I2-2.25P10	I2-2.25P10-H	I2-2.25C10	20	0.79	27	1.06
3.5	13	0.50	I2-2.25P13	I2-2.25P13-H	I2-2.25C13	25	0.98	45	1.77
	19	0.75	I2-2.25P19	I2-2.25P19-H	I2-2.25C19	32	1.26	95	3.74
	25	1.00	I2-2.25P25	I2-2.25P25-H	/	55	2.17	160	6.30
5	29	1.125	I2-2.25P29	I2-2.25P29-H	/	62	2.44	200	7.87
	6	0.25	I2-3.5P6	I2-3.5P6-H	I2-3.5C6	12	0.47	17	0.67
	10	0.375	I2-3.5P10	I2-3.5P10-H	I2-3.5C10	20	0.79	38	1.50
7.5	13	0.50	I2-3.5P13	I2-3.5P13-H	I2-3.5C13	22	0.87	65	2.56
	19	0.75	I2-3.5P19	I2-3.5P19-H	/	40	1.57	150	5.91
	25	1.00	I2-3.5P25	I2-3.5P25-H	/	50	1.97	210	8.27
10	6	0.25	I2-5P6	I2-5P6-H	I2-5C6	12	0.47	25	0.98
	10	0.375	I2-5P10	I2-5P10-H	I2-5C10	20	0.79	55	2.17
	13	0.50	I2-5P13	I2-5P13-H	I2-5C13	22	0.87	100	3.94
15	19	0.75	I2-5P19	I2-5P19-H	/	40	1.57	210	8.27
	25	1.00	I2-5P25	I2-5P25-H	/	45	1.77	250	9.84
	6	0.25	I2-7.5P6	I2-7.5P6-H	I2-7.5C6	15	0.59	30	1.18
20	10	0.375	I2-7.5P10	I2-7.5P10-H	/	18	0.71	40	1.57
	13	0.50	I2-7.5P13	I2-7.5P13-H	/	25	0.98	80	3.15
	19	0.75	I2-7.5P19	I2-7.5P19-H	/	27	1.06	220	8.66
25	6	0.25	I2-10P6	I2-10P6-H	/	13	0.51	45	1.77
	10	0.375	I2-10P10	I2-10P10-H	/	15	0.59	100	3.94
	13	0.50	I2-10P13	I2-10P13-H	/	25	0.98	120	4.72
30	19	0.75	/	I2-10P19-H	/	30	1.18	270	10.63
	6	0.25	/	I2-15P6-H	/	13	0.51	40	1.57
	10	0.375	/	I2-15P10-H	/	20	0.79	120	4.72
40	13	0.50	/	I2-15P13-H	/	23	0.91	220	8.66
	3	0.125	/	I2-20P3-H	/	7	0.28	20	0.79
	6	0.25	/	I2-20P6-H	/	14	0.55	60	2.36
50	25	1.00	/	I2-25P3-H	/	10	0.39	23	0.91